

AREA PER EDILIZIA ECONOMICA POPOLARE

A 3 DESTINAZIONE D'USO DEL SUOLO

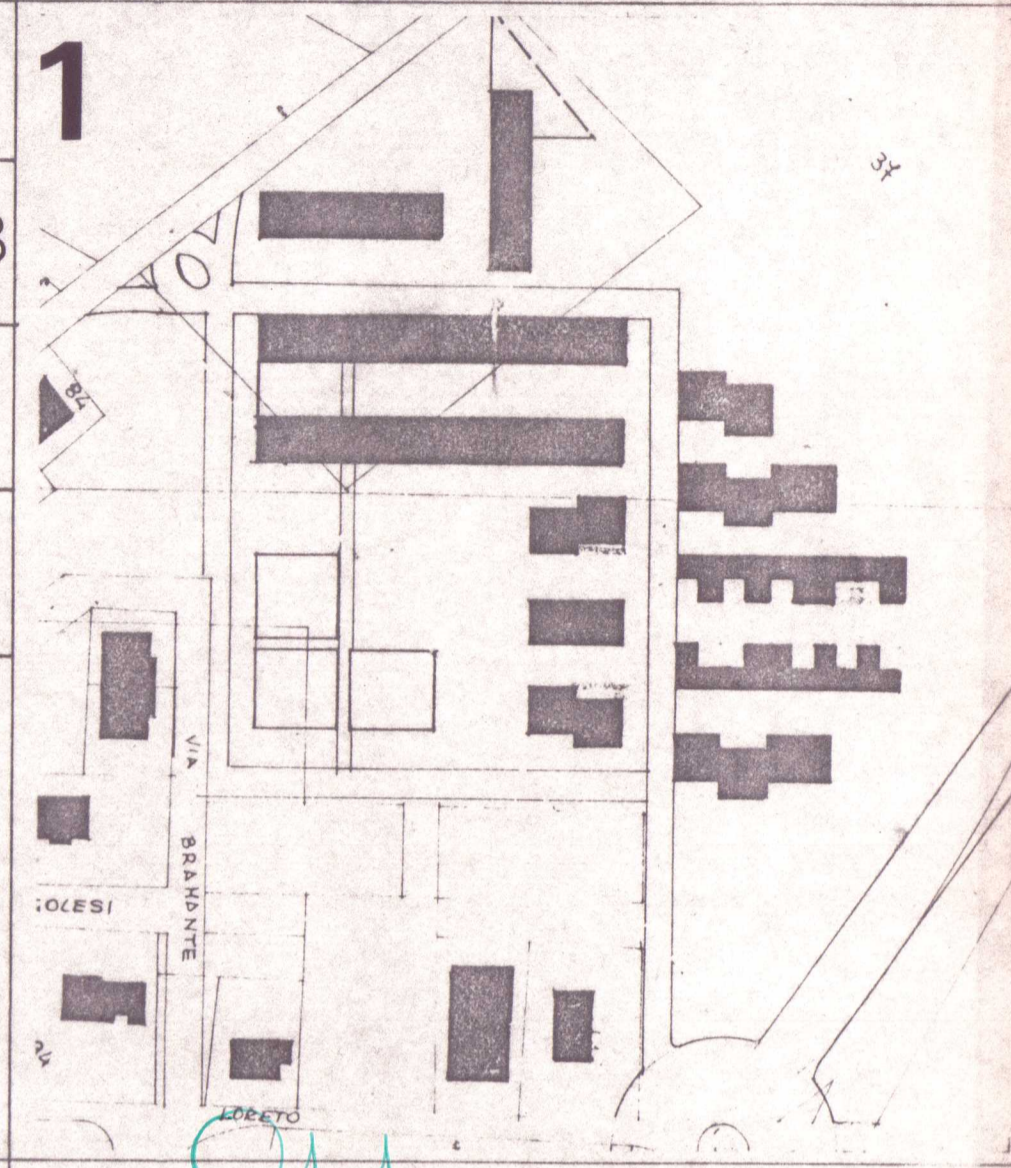



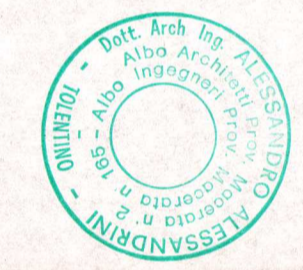

VARIANTE 1

OTTOBRE 83



Alessandro Alessandrini  
Ingegnere Architetto  
via s. nicola 66 - telentino  
tel. (0733) 972516 - 972407  
c.f. LSS LSN 47802 2474V  
p. iva 00773010434

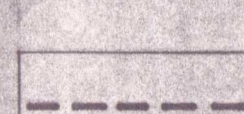

-  VIABILITA' DI QUARTIERE E DI COMPARTO
-  SPAZI DI VERDE PUBBLICO ATTREZZATO
-  SPAZI DI SOSTA E PARCHEGGIO
-  AREE DESTINATE ALLA RESIDENZA
-  SPAZI VERDE PRIVATO
-  AREE DI SERVIZIO ALLA RESIDENZA
-  AREE (F) DI P.F.
-  LIMITI DI PIANO

